

## ADD-A-MOTOR PART INSTALLATION

Motor housing has 9 screws (refer to Screw Index).  
It is **very important** that correct screws are installed back in locations shown.  
**DO NOT** over-tighten these screws because that can damage the housing.

SCREW INDEX	
Screw 1:	2-1/4" long (2 each)
Screw 2:	3/4" long (2 each)
Screw 3:	1/2" long (3 each)
Screw 4:	1" long (2 each)

**STEP 1:** Remove Screws #1 and #2. Then, lift-off Rear-Cover to access interior.



### STEP 2:

- Leave Red & Black wires attached to motor terminals.
- Carefully bend both motor terminals up to vertical.
- Grasp Circuit Board, lift up and unsnap it from its 2 mounting posts.
- Remove both Screws #3.

**STEP 3:** Leave wires attached to motor terminals.  
Separate housings. Guide the Circuit Board out.



**STEP 4:** Remove Screws #4.

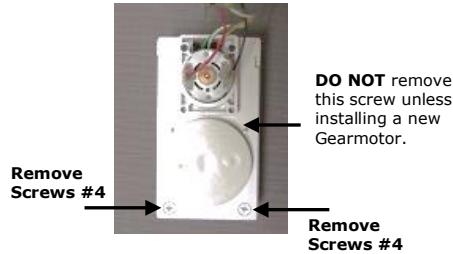

Open housing as shown.

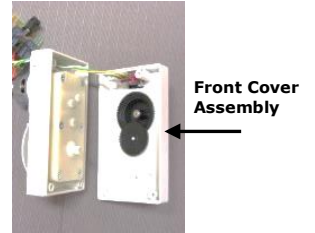

## ADD-A-MOTOR PART INSTALLATION

Motor housing has 9 screws (refer to Screw Index).  
It is **very important** that correct screws are installed back in locations shown.  
**DO NOT** over-tighten these screws because that can damage the housing.

SCREW INDEX	
Screw 1:	2-1/4" long (2 each)
Screw 2:	3/4" long (2 each)
Screw 3:	1/2" long (3 each)
Screw 4:	1" long (2 each)

**STEP 1:** Remove Screws #1 and #2. Then, lift-off Rear-Cover to access interior.



### STEP 2:

- Leave Red & Black wires attached to motor terminals.
- Carefully bend both motor terminals up to vertical.
- Grasp Circuit Board, lift up and unsnap it from its 2 mounting posts.
- Remove both Screws #3.

**STEP 3:** Leave wires attached to motor terminals.  
Separate housings. Guide the Circuit Board out.

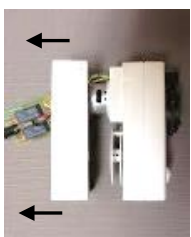

**STEP 4:** Remove Screws #4.



Open housing as shown.

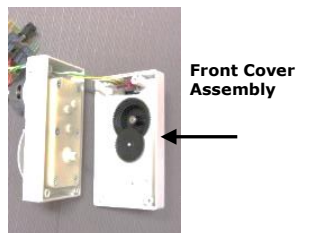

## REMOVE BROKEN DRIVE SHAFT

1. Example of broken Drive Shaft stub protruding from Gearmotor.
  2. Turnover. Push gear-end of Drive Shaft **only** in direction shown.
- CAUTION:** Force needed. Protect hands, housing and motor.

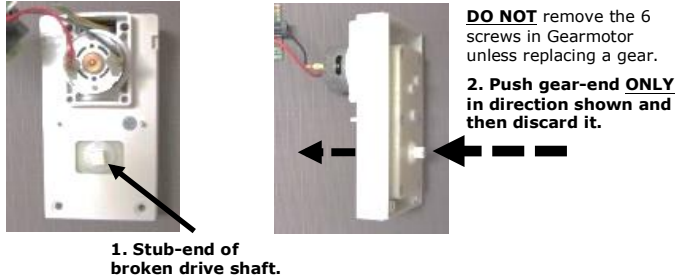

## INSTALL NEW DRIVE SHAFT

Side 2 of 2

- Install new Drive Shaft by pushing **only** in direction shown. Push thru Gearmotor hub until gear-end protrudes **fully**.

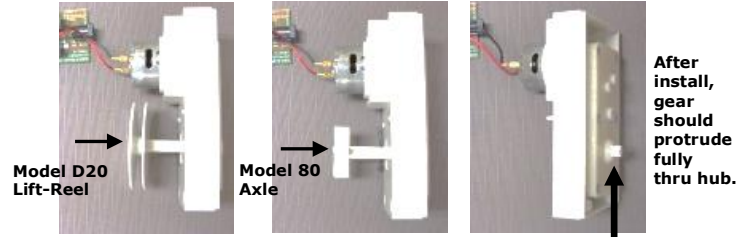

## REPLACE FRONT COVER ASSEMBLY

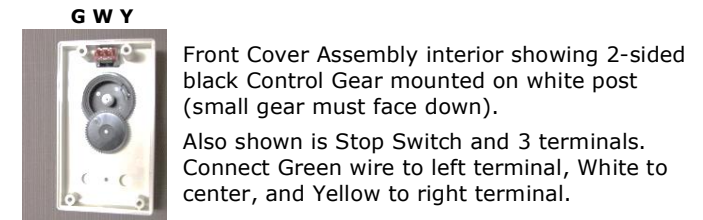

## VERY IMPORTANT – MODEL 80 DRAPERIE MOTOR ONLY – TO PREVENT DAMAGE:

1. **BEFORE** installing motor, **OPEN** drapery **HALFWAY**.
2. **IF EVER** drapery does not close properly, make **BOTH** adjustments below **soon as possible**:
  - A. **ADJUST** motor to STOP as soon as drapery is fully closed, **and also ...**
  - B. **ADJUST** motor to STOP **4 inches** or more **BEFORE FULL OPEN**.
3. **ALWAYS, ALWAYS, ALWAYS** keep motor adjusted to **STOP 4 inches** or more **BEFORE FULL OPEN**.

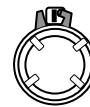

## REMOVE BROKEN DRIVE SHAFT

1. Example of broken Drive Shaft stub protruding from Gearmotor.
  2. Turnover. Push gear-end of Drive Shaft **only** in direction shown.
- CAUTION:** Force needed. Protect hands, housing and motor.

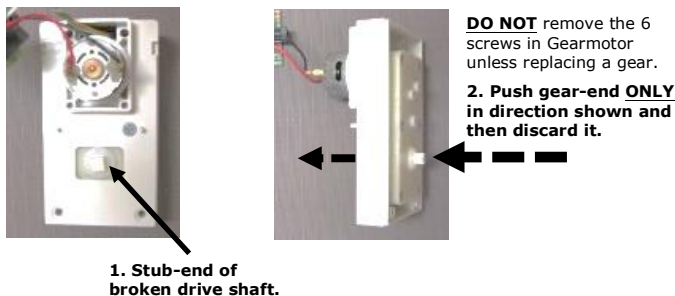

## INSTALL NEW DRIVE SHAFT

Side 2 of 2

- Install new Drive Shaft by pushing **only** in direction shown. Push thru Gearmotor hub until gear-end protrudes **fully**.

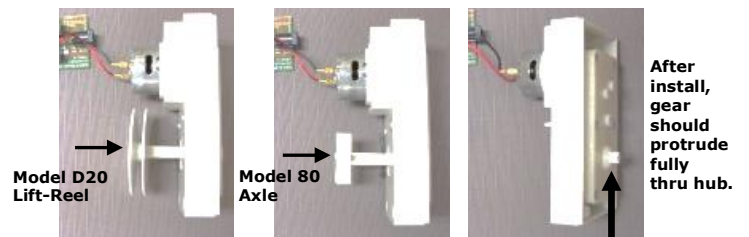

## REPLACE FRONT COVER ASSEMBLY

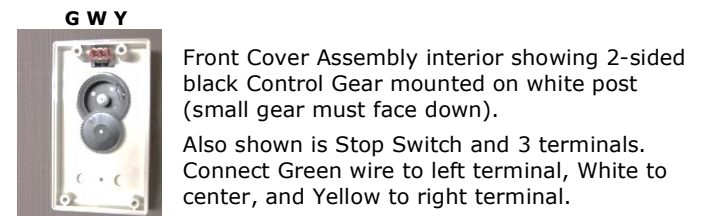

## VERY IMPORTANT – MODEL 80 DRAPERIE MOTOR ONLY – TO PREVENT DAMAGE:

1. **BEFORE** installing motor, **OPEN** drapery **HALFWAY**.
2. **IF EVER** drapery does not close properly, make **BOTH** adjustments below **soon as possible**:
  - A. **ADJUST** motor to STOP as soon as drapery is fully closed, **and also ...**
  - B. **ADJUST** motor to STOP **4 inches** or more **BEFORE FULL OPEN**.
3. **ALWAYS, ALWAYS, ALWAYS** keep motor adjusted to **STOP 4 inches** or more **BEFORE FULL OPEN**.

